

Metal Housing for Swipe Magnetic Card Reader

V3A4-AV



Heavy Duty Metal Housing

made of aluminium

with wall mounting plate

designed for Omron HNR serie (magnetic swipe readers)

standard built-in interface available (TTL level - Keyboard Emulator - RS 232)

color : aluminium grey

standard printing : card orientation and arrow

customized color or printing on request

• TECHNICAL DATA

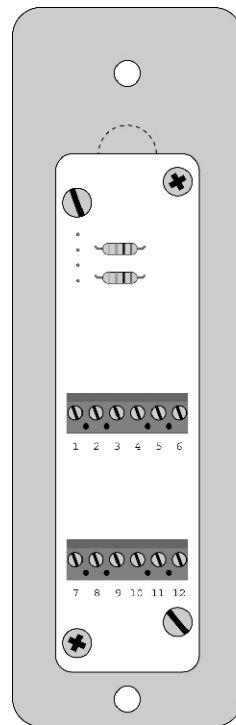
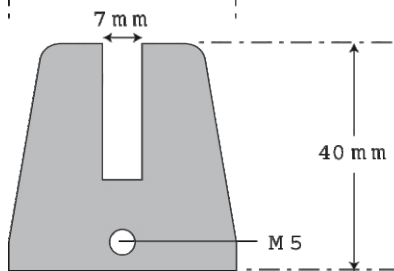
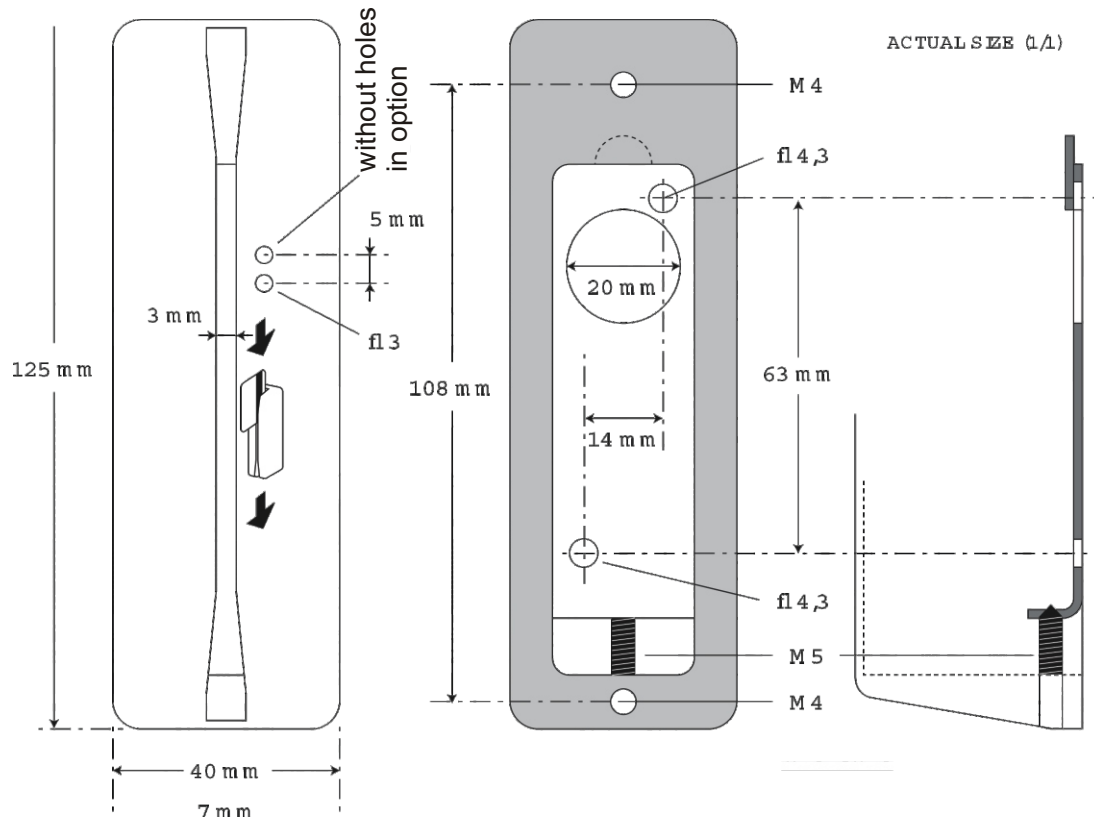

Signal assignment for "TTL Level" interface

1	NC
2	CLS
3	RDP
4	RCP
5	+5V
6	GND
7	BUZZER
8	BUZZER
9	LED RED -
10	LED RED +
11	LED GREEN -
12	LED GREEN +

V3A4-AV



Features

- Length is 90 mm.
- Low power C-MOS Technology
- TTL - compatible interface (clock & data)
- Available with or without cover
- Cable Harness is optional

Example on applications

- POS/PIN-PAD Terminals
- Cash Dispenser

	Model	Metal housing		V3A4
Magnetic Stripe	ISO 1			R
	ISO 2			R
	ISO 3			R
	Cover			Yes
	Cable			
	Color	Aluminum		
	Interface			TTL
	Power supply			5VDC \pm 10%
	Dimensions (WxDxH mm)	125x40x40		
	Note			

R: Read Only, R/W: Read & Write